

GATEWAY COLLEGE OF ARCHITECTURE AND DESIGN - SONIPAT

ARCHITECTURAL DESIGN - VIII



KINDLY SCAN FOR
WALKTHROUGH

MEHIKA SAXENA
GCAD16214
SECTION :B

Hotel Cum Convention Centre - Aerocity , New Delhi

Portfolio Submission



(THE EMERALD) BANQUET - 1 - 3000 SQ.M

SPACE NARRATIVE FOR
BANQUET - 1

FUNCTION STAGE

OUTDOOR EXTENSION TO
BE USED AS PARTY LAWN

TRANSLUCENT PARTITIONS TO
PROPOGATE VISUAL CONNECTIVITY,
BUT ALSO CATER TO THE PRIVACY

PARTITIONS / OPEN OR
CLOSED ACCORDING
TO USAGE

FLORAL DECORATIONS
AS PER DESIGN

BUFFET PRESENTATION
AND FOOD LAYOUT



SITTING ARRANGEMENT
ACCORDING TO
THE USAGE OF BANQUET

EBONY HARDWOOD
VITRIFIED FLOORING
CONTRASTING WITH THE
COLOUR PALLETTE
OF THE SETTING

GLASS DOORS UP TO FALSE
CEILING LEVEL TO ENHANCE
THE GRANDNESS

COLOUMN ACCORDING TO
STRUCTURE 1200X1200



VIEW FROM THE BUFFET SIDE

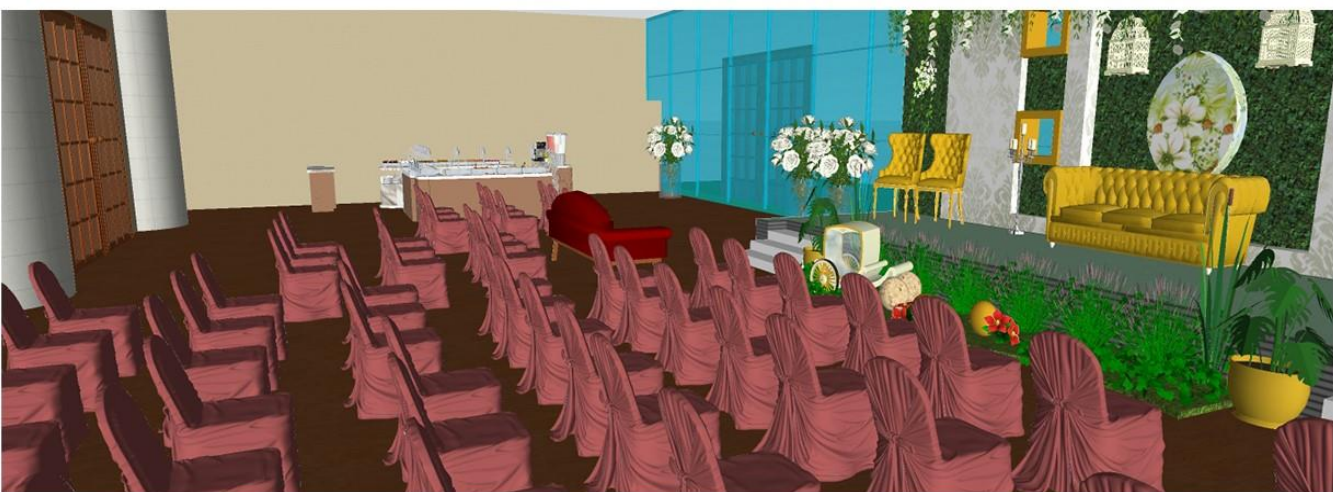

VIEW FROM THE SITTING SIDE



BANQUET HALL SETTING

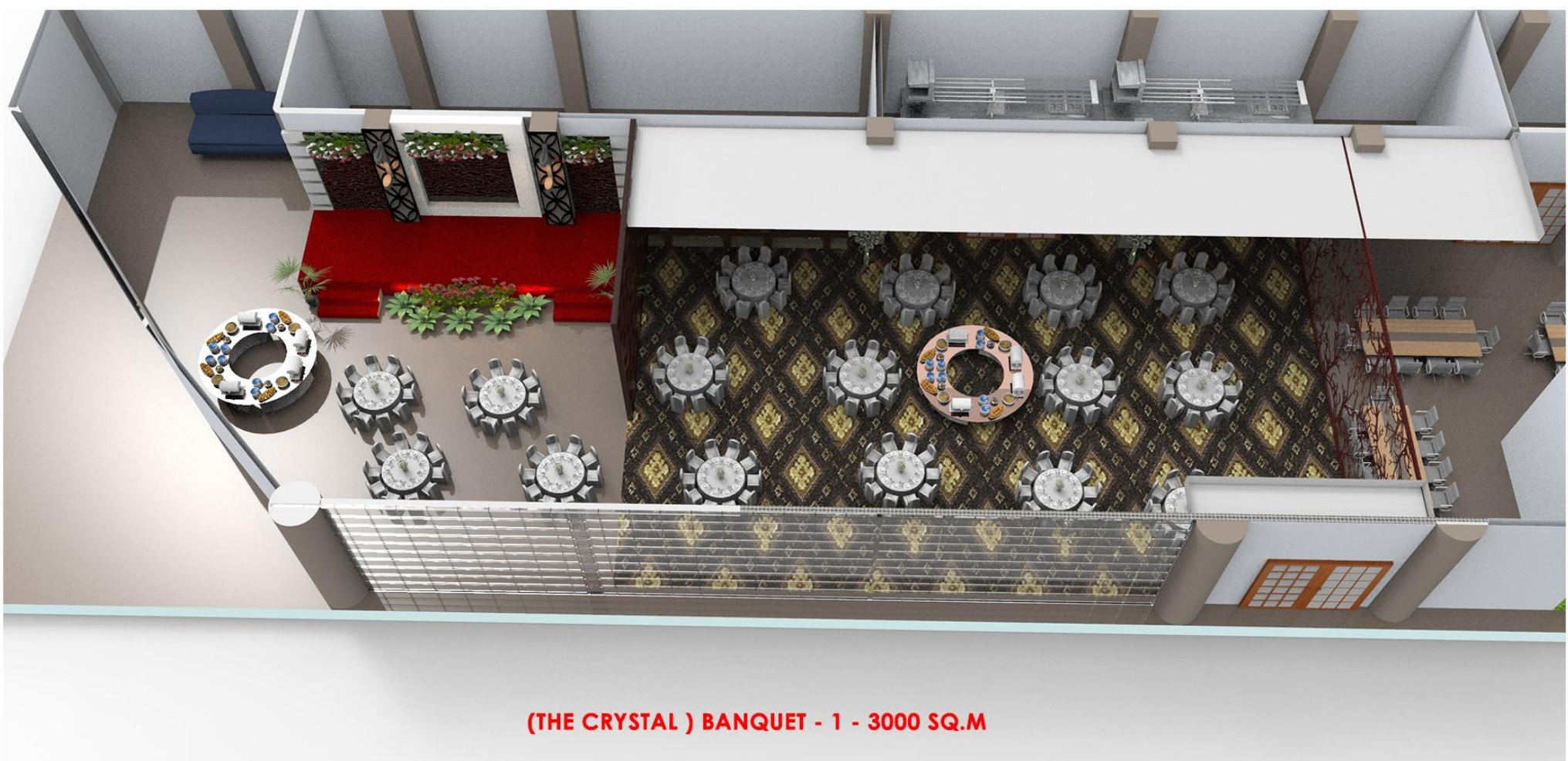

(THE CRYSTAL) BANQUET - 1 - 3000 SQ.M

SPACE NARRATIVE FOR
BANQUET - 2

FUNCTION STAGE FOR
VARIABLE USERS

EQUIPMENT
STORAGE ROOM

OUTDOOR EXTENSION
TO BE USED AS PARTY
LAWN

BANQUET SUBKITCHEN AND
SERVRY CONNECTED TO THE
MOTHER KITCHEN BELOW

GRANITE FLOORING , AS PER
DESIGN REQUIREMENT

500 SQM CRYSTAL BALL
ROOM SQUARE TABLE SETTING
FOR COOPERATE CUM , BUSI-
NESS EVENTS

TRANSLUCENT PARTITIONS TO
PROPOGATE VISUAL
CONNECTIVITY , BUT ALSO
CATER TO THE PRIVACY

GLASS PARTITIONS FOR
WITNESSING THE EXCLUSIVITY OF THE SPACE

SOLITAIRE BALL ROOM , 500 SQM CAPACITY ,
ROUND TABLE TYPE ARRANGEMENT

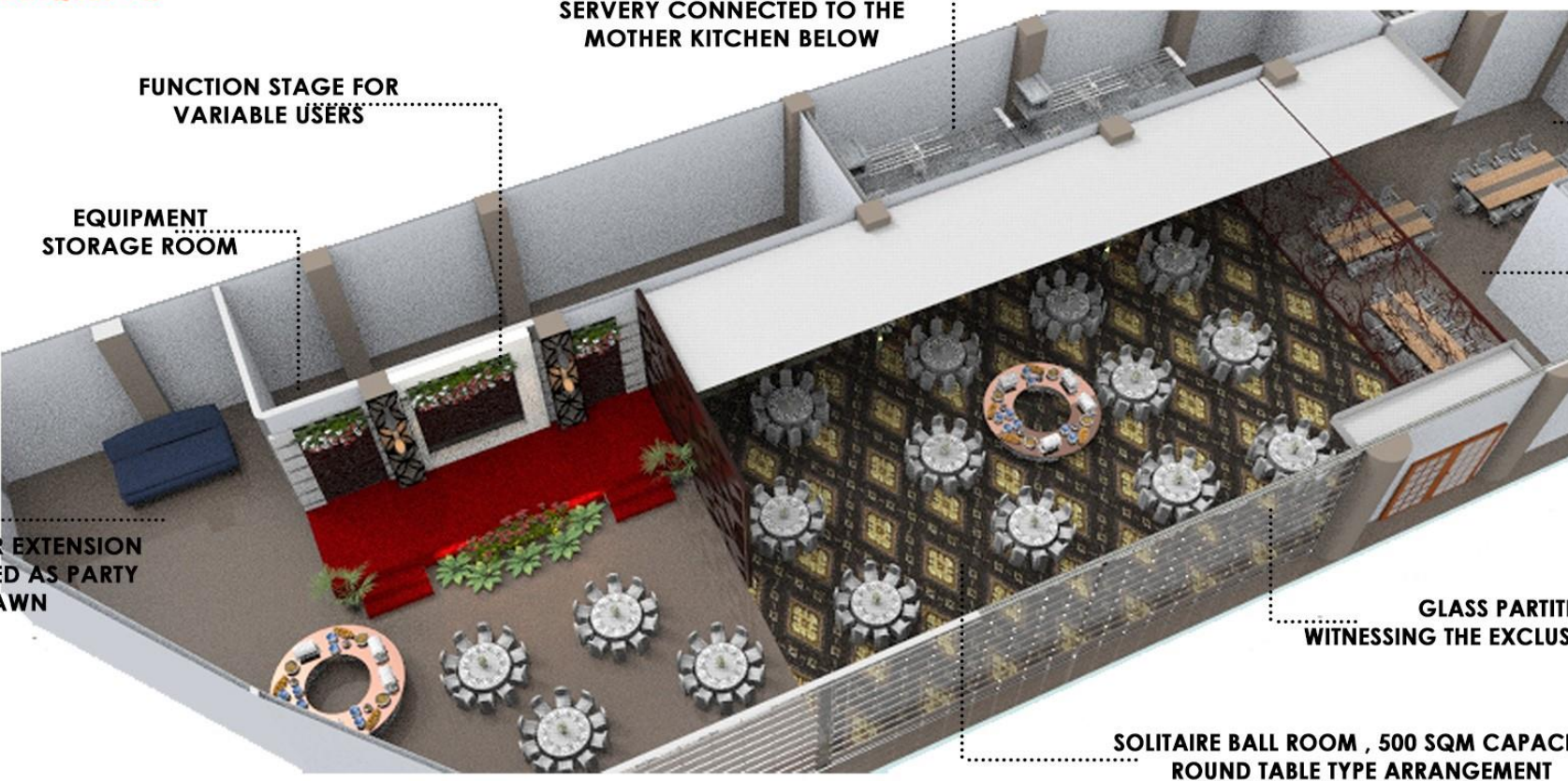

ANALYSIS AND CONCEPTUALIZATION

northern access road

aerocity

visual axis

visual axis

visual axis

visual axis

aerocity access road

mahipalpur

metro station road

SITE CONFIGURATION

FIRST THOUGHT

NARRATIVE :
The visitors will stop come at the front road , and would be able to experience the entire frontier of the hotel across its visual axis

SETTING :
convention space , hotel and banquet have separate complexes and experiences which distinguish them from each other ,but still keep the building form homogenous

WORLDMARK 1
regular punctures

JW MARRIOTT
- curvilinear profile

NOVOTEL
peripheral planning

VISUAL CONNECTIVITY

ACCESSIBILITY

HOSPITALITY

iconic: eye catching from afar

contextual: blends in with the site

functional: every user feels involved in the space

homogeneity: wholeness in the space

1

2

3

1

2

3

walking through the frontiers of the site

CHAMFERRING THE SHAPE ACCORDING TO PRE- EXISTING TYPOLOGY OF CURVES IN AEROCITY

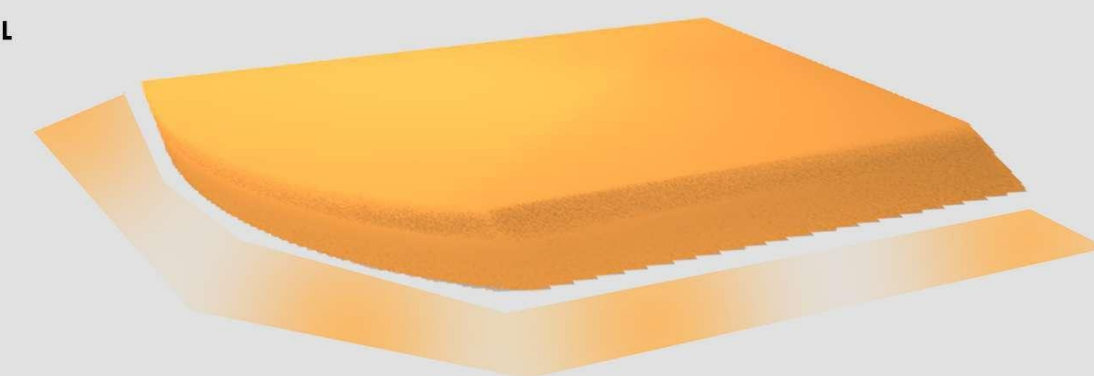

**CROSS CUTTING OF THE
FLOOR PLATES TO DEVELOPE
A SENSE OF MOVEMENT
ALONG THE SITE**

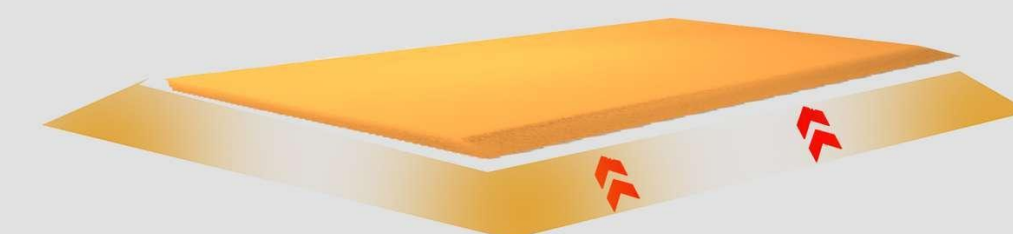

DIVIDING THE FLOOR PLATES ACCORDING TO THE FUNCTION

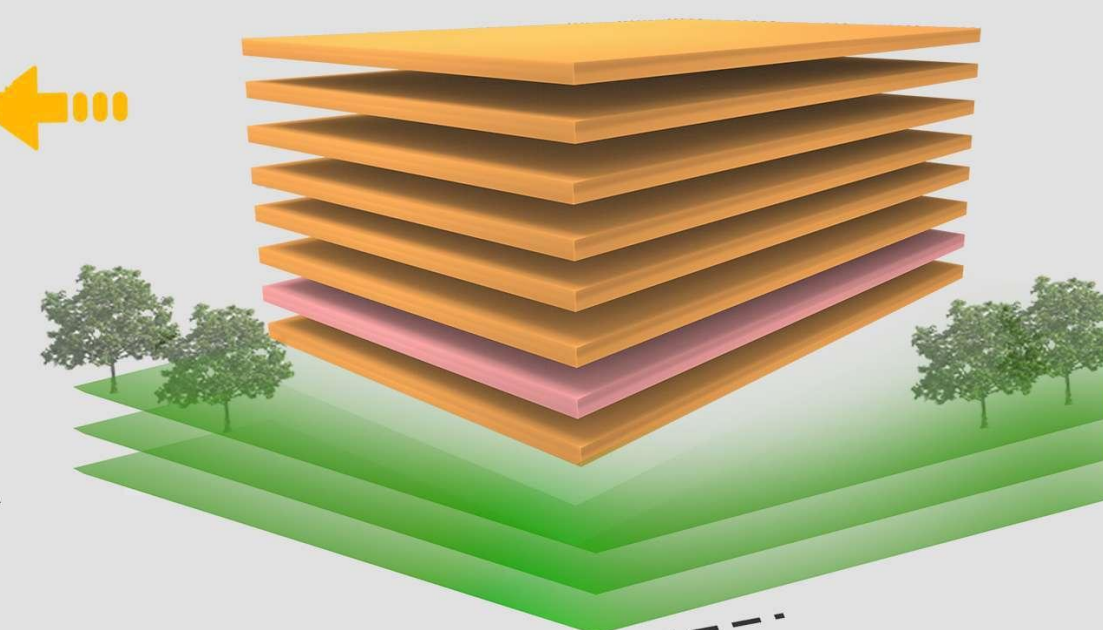

FORM APPLICATION

OVERVIEW - 1 : ELEVATION EXTRUSION OF THE SITE - 36M ABOVE THE NGL AND 13M BELOW THE NGL .

OVERVIEW - 2 : MAJOR GREENS IN THE SITE
15 GREEN PATCHES ALONG THE PERIPHERY OF THE BUILDING + 3 ADDITIONAL LAWNS

OVERVIEW - 3 : TRANSPARENT TO OPAQUE FACADE RATIO
DEMACRATION FOR UNDERSTANDING THE VISIBILITY TO AND FROM BUILDING

OVERVIEW - 4 TERRACE AREA AVAILABLE FOR INSTALLATION OF SOLAR PANELS ON 80% OF THE SURFACE , FOR A SUSTAINABLE APPROACH TOWARDS FOR THE HOTEL

OVERVIEW - 5 PUNCTURES IN THE SITE -
2 ENTRIES AND 2 EXITS FOR BIFRACTED VEHICULAR CIRCULATION

ADDING FACADE ELEMENTS

FORMATION OF DIFFERENT BUILDING BLOCKS. ATRIUM IN THE MIDDLE OF THE HOTEL FOR VIEW

VERTICAL STACKING - DIVISION OF SPACES

BANQUET SPACE = 10,000SQ.M
LOBBY = 6,000 SQ BOTH FLOORS
ROOMS = 12,000SQ.M
RESTAURANT = 500 SQ.M + MEZZANINE
RETAIL = 10,000SQ.M

PROS

- RETAIL SPACE HAS A PEDESTRIAN COURTYARD THAT THE VISTORS CAN EXPERIENCE
- CONVENTION CENTRE HAS A BREAKOUT SPACE OVER THE RETAIL ZONE
- ROOMS WILL HAVE POOL SIDE VIEW AND CITY SIDE VIEW
- GYM HAS AN ENTRANCE FROM THE SWIMMING POOL AREA
- RESTAURANT HAS A MEZZANINE DECK FOR FINE DINNING EXPERIENCE
- SEPERATE ENTRY AND EXIT FOR BANQUET USERS
- LOBBY AREA HAS A DULATED SITTING PLAN
- EXHIBITION ZONE IS INTERCONNECTED WITH BANQUET AREA

convention centre
retail
restaurant
lobby
rooms
banquet
banquet

CONCEPTUALIZATION AND VISUALIZATION

HOTEL CUM CONVENTION CENTRE - AEROCITY , NEW DELHI

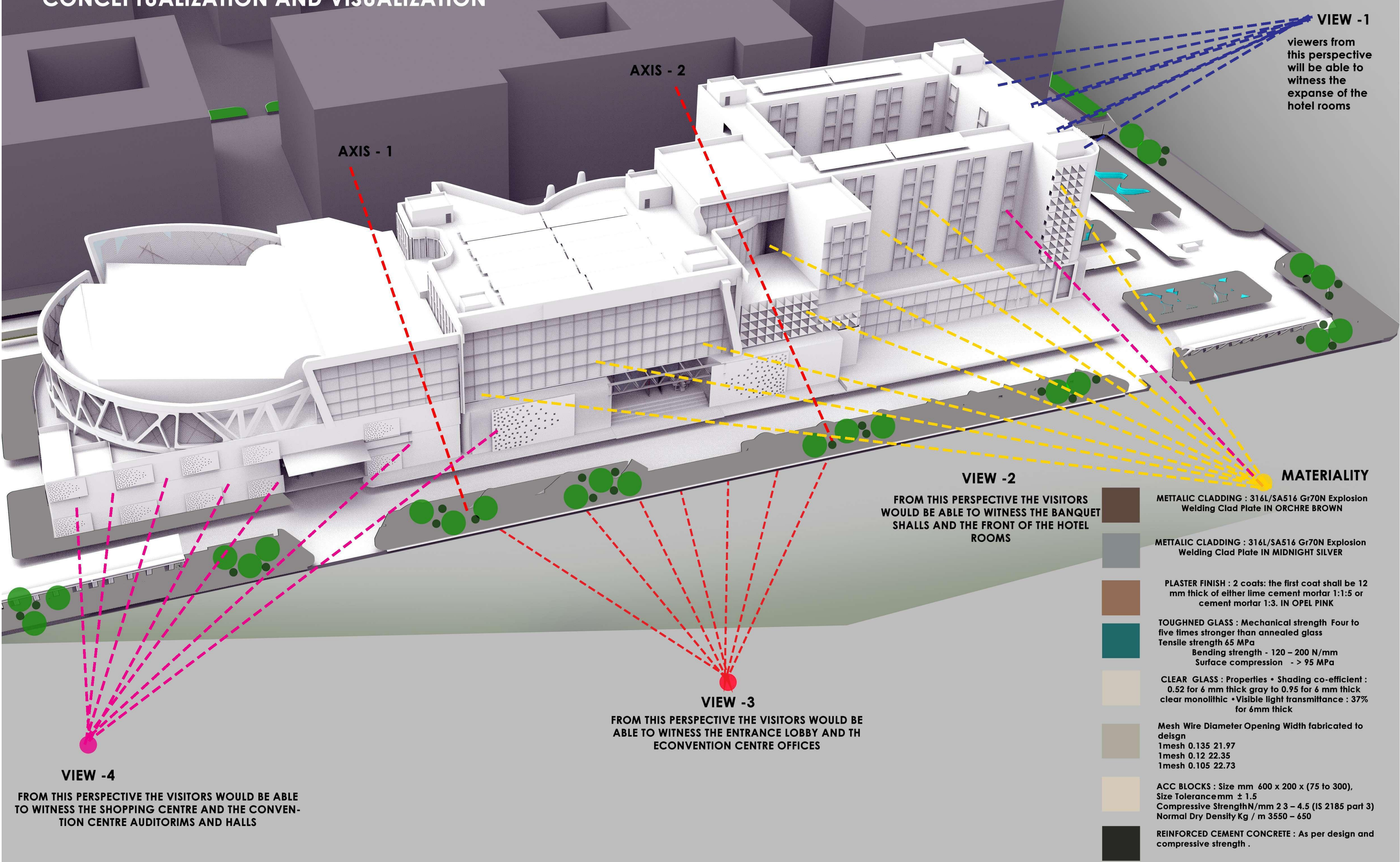

FRONT ELEVATION - HOTEL CUM CONVENTION CENTRE - AEROCITY , NEW DELHI



CONVENTION AND RETAIL SPACES

HOTEL LOBBY AND OFFICES

BANQUET AND HOTEL ROOMS

A space that redefines the co-operate scenario by indulging the guests into a wholesome experience , luxurious shopping emporio- that transports the user into the realm of comfort

spaces speacially incorporated for merging the business , with recreation , and facilitating the event .

A 5000sq.m banquet space with outdoor extensions , that combine lodging with hospitality , and creates an aura of serenity

